

PROCEDURE FOR SETTING UP A LAPTOP AND PROJECTOR FOR POWERPOINT SLIDE SHOWS

- 1) CONNECT LAPTOP AND PROJECTOR WITH A 15-PIN SERIAL CABLE.
- 2) POWER-UP BOTH DEVICES.
- 3) WHEN THE DESKTOP APPEARS, PRESS AND HOLD THE WINDOWS KEY, THEN TAP THE 'P' KEY TO DISPLAY THE PROJECT MENU. AS NECESSARY, TAP THE 'P' KEY AGAIN TO STEP THROUGH THE MENU TO HIGHLIGHT THE Duplicate SELECTION. RELEASE THE WINDOWS KEY.
- 4) LAUNCH THE POWERPOINT FILE ON THE LAPTOP.

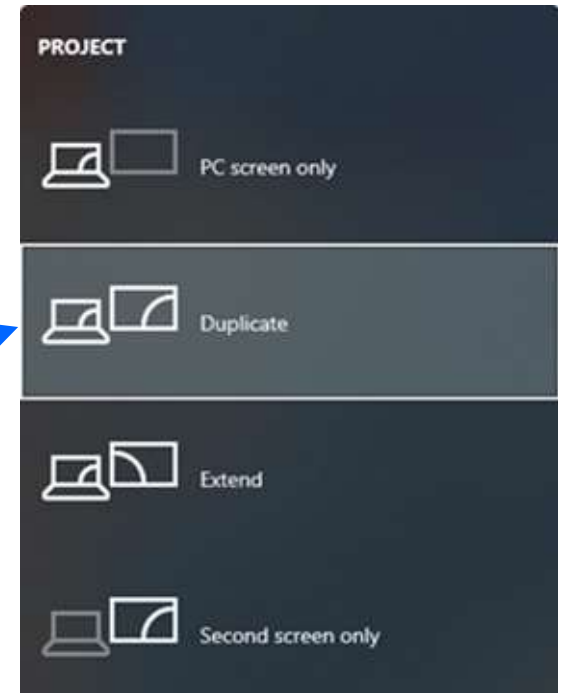

- 5) SELECT Slide Show ON THE MENU BAR.
 - 6) IN THE RIBBON, MAKE SURE Use Presenter View IS SELECTED.
 - 7) CLICK ON From Beginning.
- THIS SHOULD RESULT IN THE SCREEN VIEWS SHOWN ON THE NEXT PAGE.

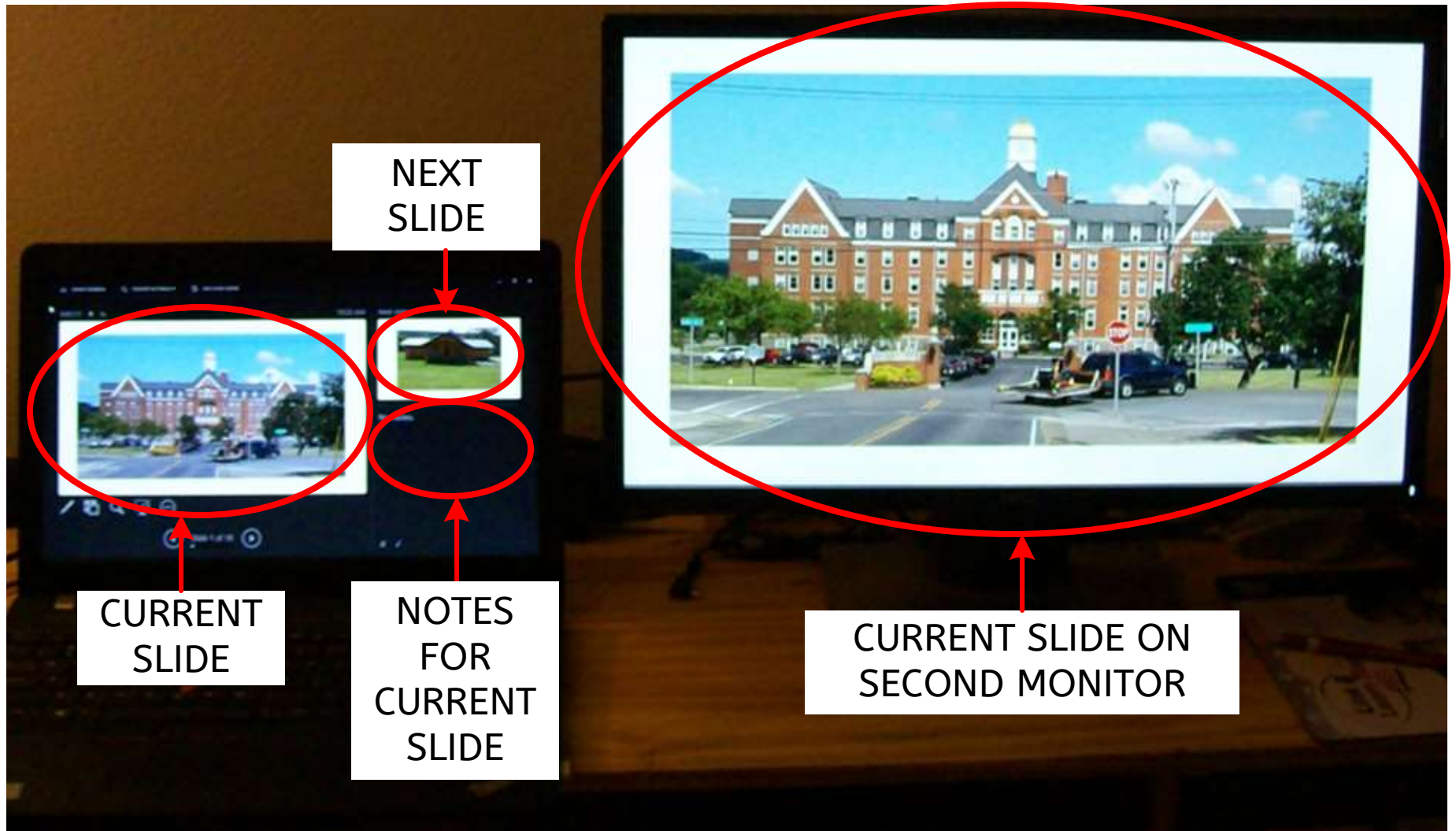

NEXT
SLIDE

CURRENT
SLIDE

NOTES
FOR
CURRENT
SLIDE

CURRENT SLIDE ON
SECOND MONITOR